

# ANNEXURE C FLOOR PLANS

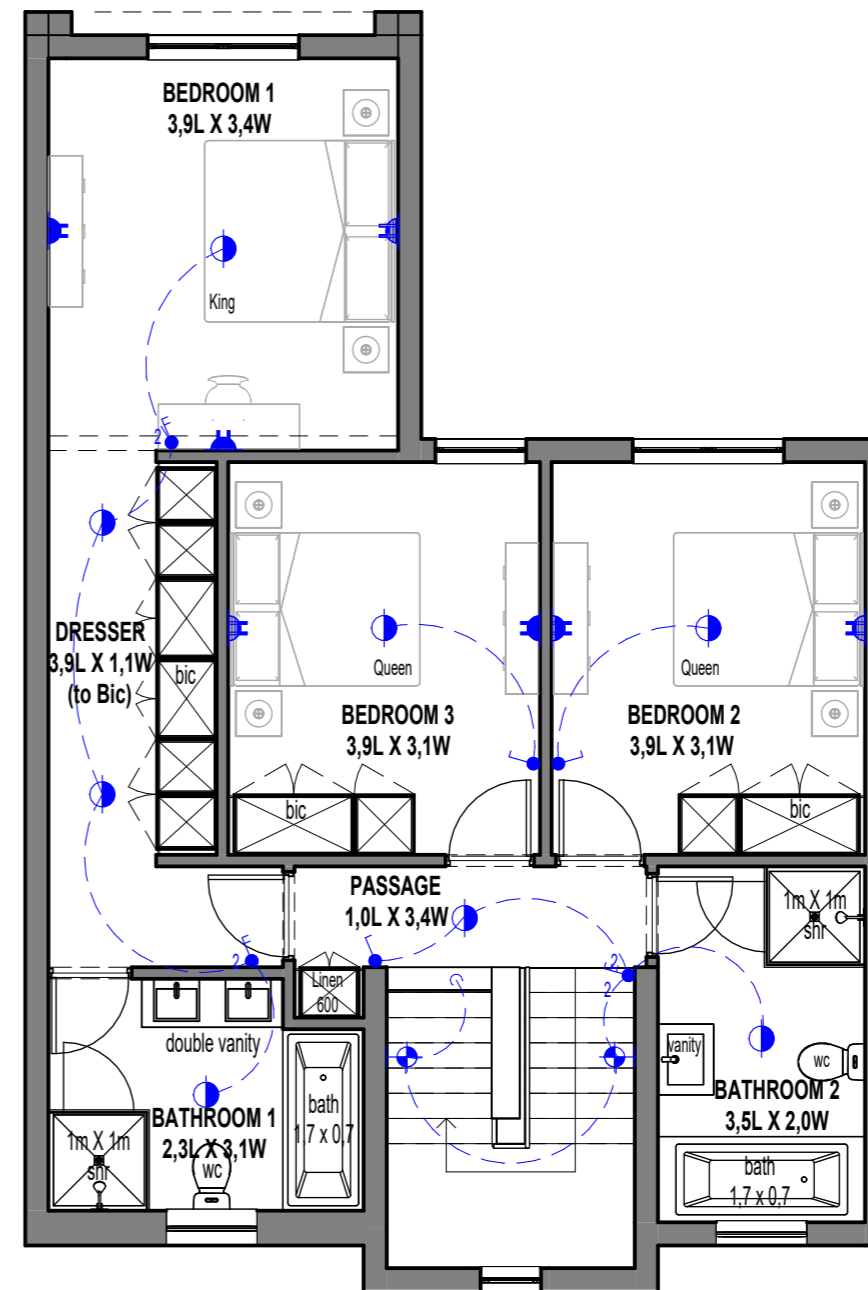
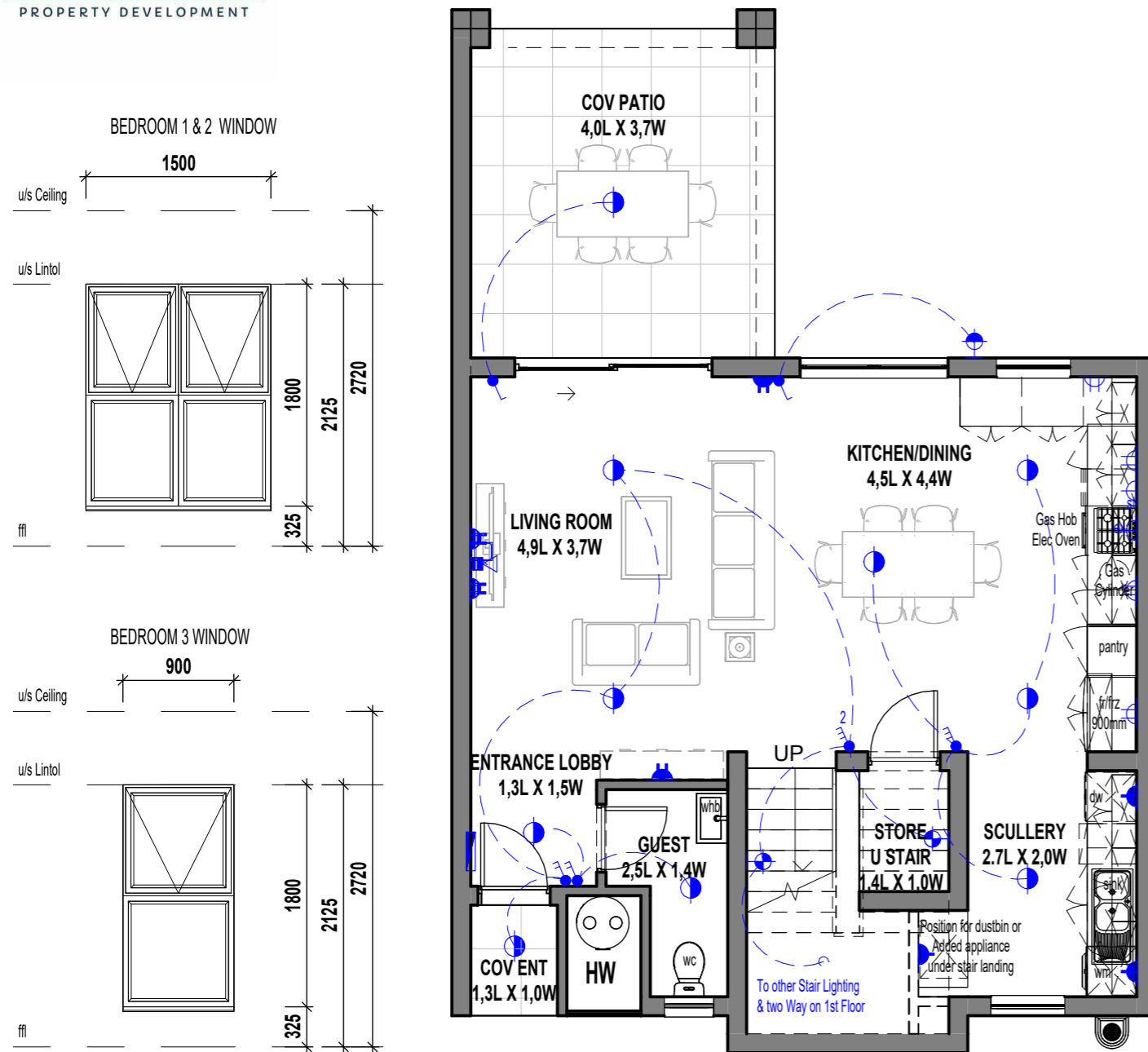

## Duplex 3 Bedroom - 2,5 Bathroom

GROUND FLOOR PLAN

1ST FLOOR PLAN

SCALE 1:75

### ELECTRICAL LEGEND

- Surface Mounted LED Fitting
- External Wall Mounted LED Light Fitting
- LED Strip Light Fitting (u/s - Eye levels - Kitchen)
- Single Light Switch
- Double Light Switch
- Triple Light Switch
- Two-Way Light Switch
- Single Plug Point (300mm Above FFL)
- Double Plug Point (300mm Above FFL)
- Single Plug Point (150mm Above Counter)
- Double Plug Point (150mm Above Counter)
- Stove Isolator (Above Counter)
- Extractor Plug (High Level)
- Distribution Board
- TV Point
- Fibre / Data Point
- Inverter

### AREA

TYPE F2	Area
Ground Floor	66.88 m <sup>2</sup>
Cov Patio	15.28 m <sup>2</sup>
Cov Ent	1.59 m <sup>2</sup>
1st Floor	84.22 m <sup>2</sup>
<b>Total</b>	<b>167.97 m<sup>2</sup></b>

F2

\* The areas are approximate and shall vary from the areas reflected on the sectional title plan